

LOWER LEVEL

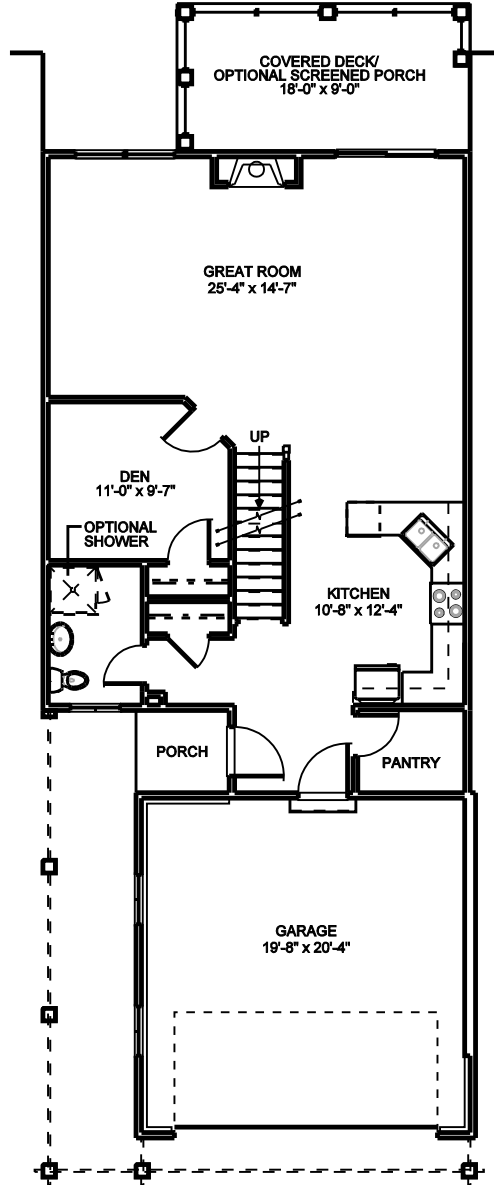

FIRST FLOOR

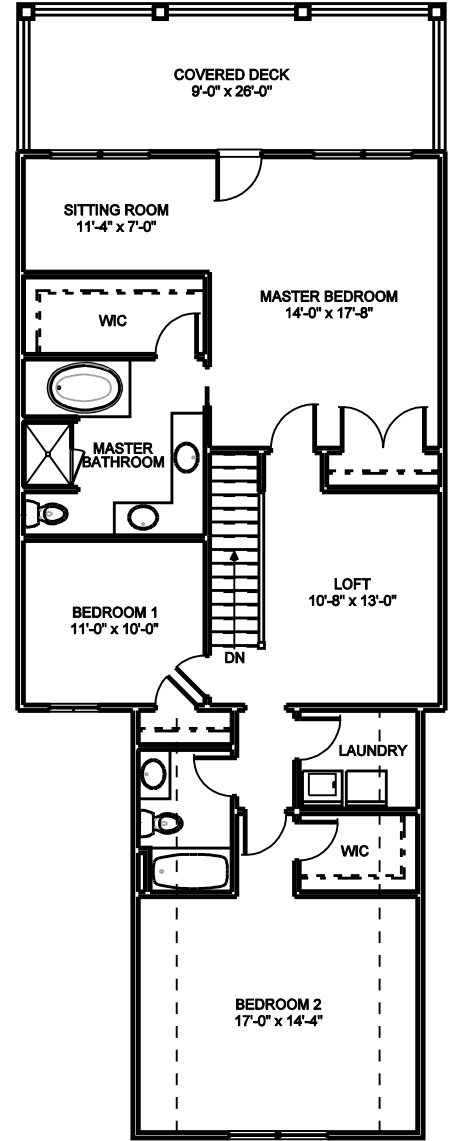

SECOND FLOOR

SPECIFICATIONS OF UNIT "B-2"			
FOUNDATION	FULL BASEMENT	BEDROOMS	3
FIRST FLOOR S.F.	1,196 S.F.	BATHROOMS	3
SECOND FLOOR S.F.	1,343 S.F.	GARAGE:	2 CAR
TOTAL LIVING AREA	2,539 S.F.	HOUSE	26'-0" x 69'-0"